

WORKING WITH SKY-FRAME.

EN



SKY-FRAME

**A VIEW,
NOT A
WINDOW.**

Working with Sky-Frame means creating living environments of unparalleled beauty, comfort and elegance. The frameless sliding window is a modular system that combines Swiss engineering ingenuity with timeless style, resulting in architectural elements that exude quality in every regard.



SKY-FRAME PRODUCTS.

The various systems can be combined with glass panels of different thicknesses and thus provide an aesthetically pleasing solution with a range of useful functions. As soon as you have chosen the ideal system, the appropriate glazing can be selected. You can further tailor your system with a wide selection of additional features.



CLASSIC















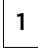

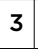
ARC

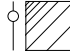

SLOPE



PIVOT

SYSTEM		CLASSIC Straight sliding doors	ARC Curved sliding doors	SLOPE Inclined sliding doors	PIVOT Pivot door
OPTION Track system	 Original Visible transition	●	●	*	
	 Plain Hidden, seamless transition	*			
TECHNOLOGY Glazing	 Sky-Frame 1 Single glazing	○			
	 Sky-Frame 2 Double-glazed insulating glass	●	○	*	●
	 Sky-Frame 3 Triple-glazed insulating glass	●	○	*	●
FEATURES	 Fly Insect screen	●			
	 Drive Electric drive	●	*	*	
	 Switch Switchable Glass	●	*		*
	 Guard Increased anti-burglary protection	●	*	*	*
	 Pocket Hidden sliding window	●	○	*	
	 Inline Flush-fitted glass panels	●	*	*	
	 Gun Bulletproof version	○			
	 Sun Shading solution	●			
	 Hurricane	○			
	 Color Customisation	●	●	●	●

● standard ○ only with the Original option * on request

SKY-FRAME PRODUCTS.

SYSTEM

Sky-Frame Classic

The rectilinear Classic window system has timeless appeal. True to the Bauhaus vision, the ceiling-height glass facades help to create a minimalist architecture in which the view takes centre stage.

For technical details, see page 08.

Sky-Frame Arc

The organic forms of the Arc model serve to soften the contours of domestic architecture. The curved sliding panels offer a bold counterpoint to the linearity of the spatial and facade composition.

For technical details, see page 10.

Sky-Frame Slope

The Slope system allows the sliding windows to be installed at an angle. The inclined glass units can either extend into the room or project outwards from the facade. The distinctive spatial geometry offers a unique living experience.

For technical details, see page 12.

Sky-Frame Pivot

Thanks to its asymmetrically positioned axis, Sky-Frame Pivot, the glass-panelled pivot door, swings open easily with just a gentle push. The multipoint locking system guarantees safety and security.

For technical details, see page 14.

OPTION



Sky-Frame Original

A feeling of vast, wide-open space, even when the windows are shut: the windows are framelessly transparent from the ceiling to the floor, which is made possible by the track system that is fully concealed in the floor. Sky-Frame Original ensures that heat and cold remain outside.

For technical details, see page 16.



Sky-Frame Plain

What sets Sky-Frame Plain apart is the hidden, seamless transition between the inside and the outside that is completely flush-fitted with the floor. The sliding door glides along a narrow gap and is fitted flush with the floor. The space between these tracks is covered by the same flooring as the interior of the room, which reinforces the feeling of a free-flowing transition between indoors and outdoors.

For technical details, see page 18.

TECHNOLOGY

1

Sky-Frame 1

The single-glazed Sky-Frame 1 system (12 mm) is suitable for applications without thermal insulation requirements.

For technical details, see page 22.

2

Sky-Frame 2

The double-glazed Sky-Frame 2 assemblies (30 mm) meet strict sound and thermal control requirements.

For technical details, see page 24.

3

Sky-Frame 3

The triple-glazed Sky-Frame 3 technology (54 mm) further enhances the thermal insulation performance to meet the most stringent standards.

For technical details, see page 26.

FEATURES



Sky-Frame Fly

Sky-Frame Fly makes it possible to enjoy summer weather without being plagued by insects. When not in use, the pleated screen fully retracts out of sight into the frame.

For technical details, see page 28.



Sky-Frame Drive

The electric drive facilitates straightforward and virtually noiseless operation of the sliding panels at the press of a button.

For technical details, see page 30.



Sky-Frame Switch

A current pulse can be used to control various properties of the window panes in order to switch seamlessly between transparency and opacity or to activate sun protection. This provides a whole new level of living comfort.

For technical details, see page 32.



Sky-Frame Pocket

When Sky-Frame Pocket is opened, the window panels slide into the wall so that living spaces are completely open, highlighting the magnificence of the interior architecture.

For technical details, see page 34.



Sky-Frame Inline

Sky-Frame Inline's elegant posts with a visible width of just 30 mm make it possible to create spectacular flush-fitted glass panels by connecting frameless fixed glass panels with sliding windows.

For technical details, see page 36.



Sky-Frame Guard

The Sky-Frame sliding window system is burglar-resistant and can, where required, be fitted with laminated safety glass and additional security hardware concealed in the frame. Alarm sensors can also be integrated to monitor the windows.

For technical details, see page 38.



Sky-Frame Gun

Security means quality of life. That is why Sky-Frame Gun features insulated security glass, reinforced frames and vertical profiles to protect against gunfire.

For technical details, see page 40.



Sky-Frame Hurricane

Sky-Frame's hurricane-tested, frameless sliding windows are some of the largest on the international market. They comply with the criteria for the authoritative standard of the industry – High Velocity Hurricane Zone (HVHZ) according to the Florida Building Code.

For technical details, see page 42.



Sky-Frame Sun

The Sky-Frame Sun solar shading assembly offers protection against heat and strong sunshine. The flat aluminium slats are suspended on thin guide cords that are easy to remove and fix back in place whenever necessary.

For technical details, see page 46.



Sky-Frame Color

Sky-Frame offers the window profiles with colourless anodisation. Alternatively, an individual colour from the RAL, IGP or DB colour systems can be defined for the powder coating or one of six anodized colours can be selected.

For technical details, see page 48.

SKY-FRAME CLASSIC



PRODUCT VIDEO



The name “Classic” not only evokes the timeless appeal of the rectilinear window system, but also highlights its historical significance as the first-ever Sky-Frame system. The sliding windows comprise insulating glass units with perimeter aluminium or glass-fibre-reinforced plastic (GRP) sections. Mounted in streamlined aluminium frames fitted flush with floor and ceiling, each unit rolls fluidly when operated. The system drainage for the flush assembly works either via recessed channel or is installed below the raised outdoor floor covering.

Vertical floor section, Sky-Frame 2

Floor connection (scale 1:4)

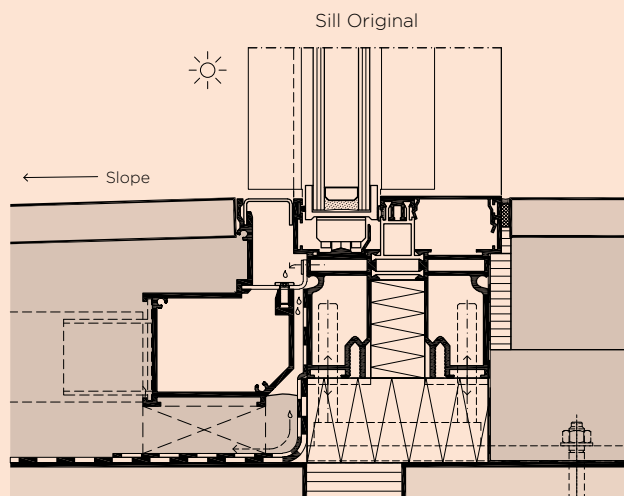
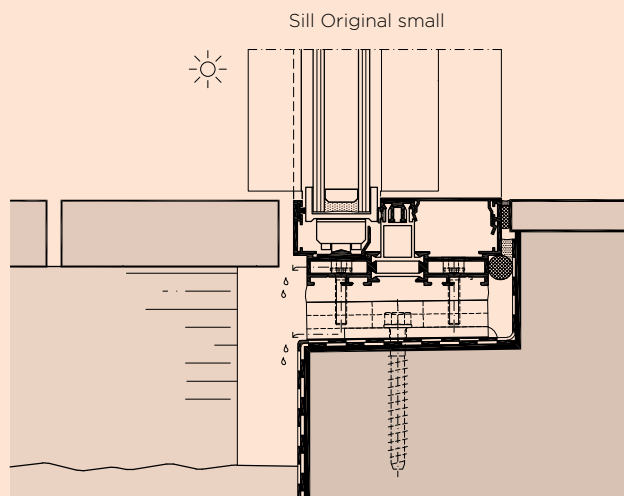

Original small sill is available for countries where a low floor structure is common and compliant.

SKY-FRAME ARC



Sky-Frame Arc offers sliding glass panels to create curved fronts that lend organic, smooth contours to a residential space. The rounded glass units offer smooth running performance and can be equipped with an automatic drive. Meeting all Sky-Frame standards, the streamlined Arc system is an architectural feature that inspires endless additional design options.

Opening options

Straight edge (Classic) and curve (Arc) combination
Curve combination (Arc)

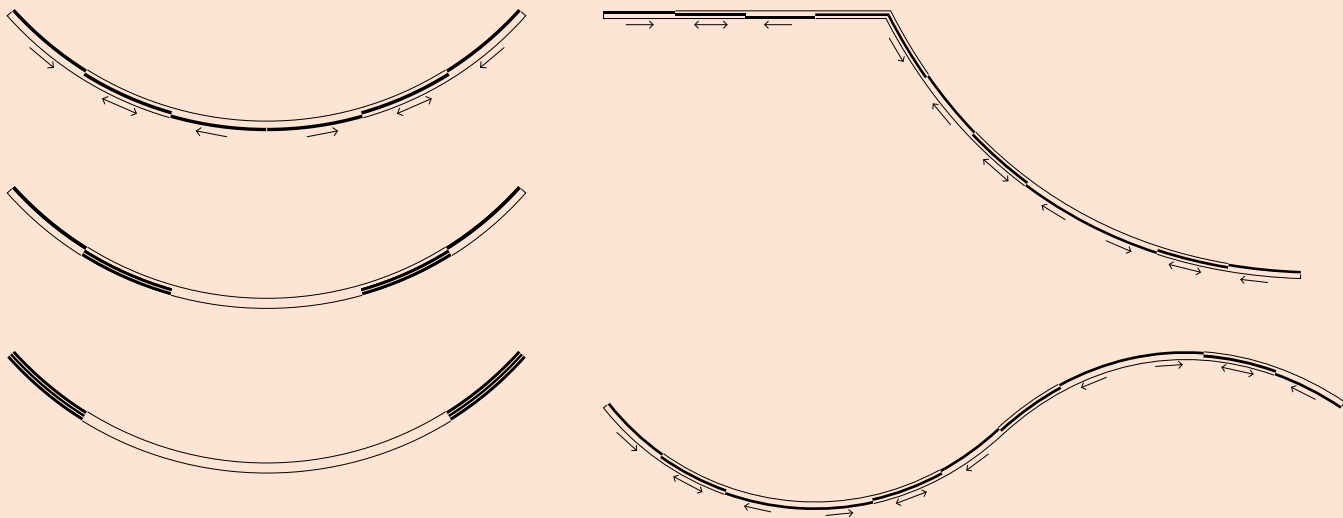

Feasibility

The following radii and sizes can easily be fabricated:
(other radii and wider elements upon request)

Sky-Frame 2 + 3	Sliding elements	Fixed elements
2-tracks	R = 3.5 - 10 m	R = 2.5 - 10 m
3-tracks	R = 5.0 - 10 m	R = 5.0 - 10 m

Sky-Frame 3; possible with electric drive, if:

2-tracks	R = 3.8 - 10 m
3-tracks	R = 5.0 - 10 m

Sliding elements:	width × height = max. 2.0 × 3.1 m
Fixed elements:	width × height = max. 2.4 × 3.1 m

SKY-FRAME SLOPE



Sky-Frame Slope sliding windows can either extend into the room or project outwards from the facade at an angle of up to 20°. The system meets all Sky-Frame standards while generating a distinctive spatial geometry. The bearing assembly is able to accommodate all vertical and horizontal forces, thereby achieving superior running performance. Regardless of the direction of the window, the drainage system meets all requirements for driving rain resistance.

Windows can tilt either inwards or outwards

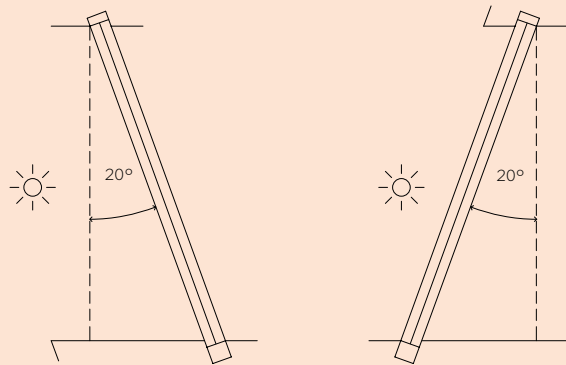

Vertical section, Sky-Frame 2
Ceiling and floor (scale 1:5)

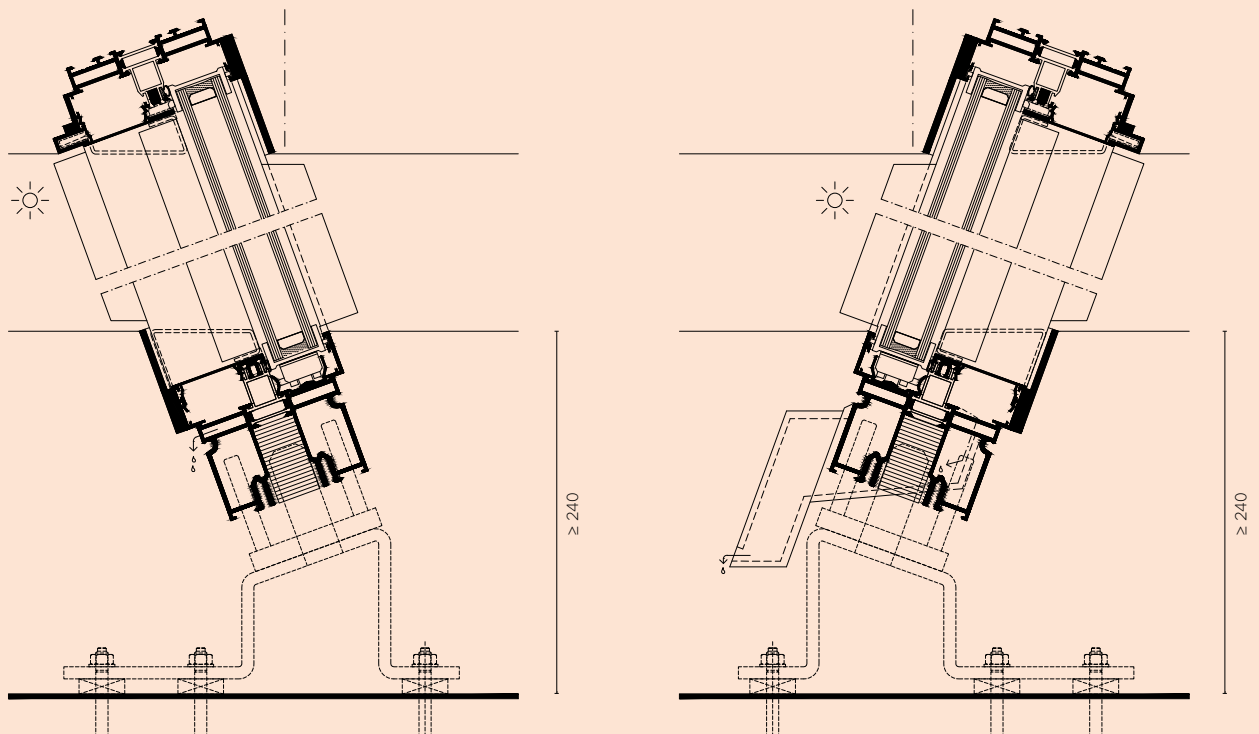

SKY-FRAME PIVOT



PRODUCT VIDEO



The Pivot system turns the simple act of opening a door into a creative experience: with a gentle push on the comfortable handle, the doors swing around the asymmetrically located axis, resulting in a temporary spatial structure. This could be the reason why Le Corbusier preferred these kinds of doors. The multipoint locking system guarantees safety and security, while the optional electromechanical locking system ensures additional ease of use.

Opening options

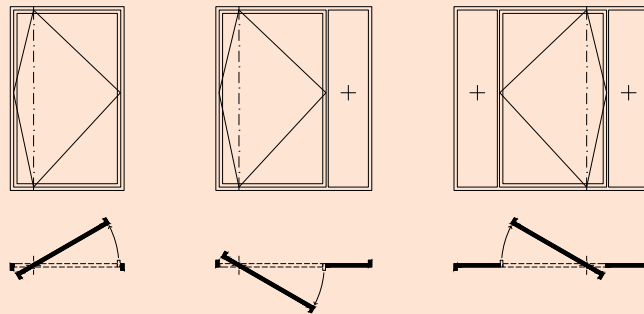

Vertical section, Sky-Frame 2

Ceiling and floor connection (scale 1:5)

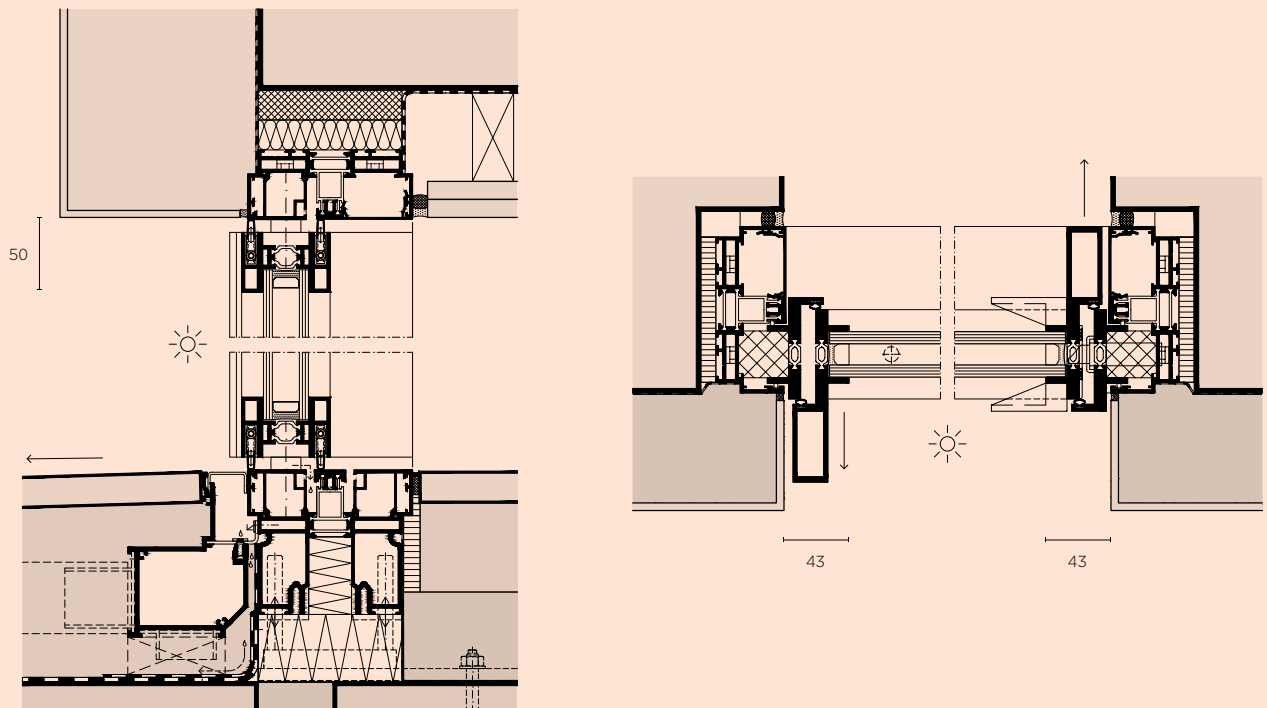

Feasibility	Technology	width × height	weight
Pivot	Sky-Frame 2 + 3	max. 2.5 × 4.5 m	max. 450 kg

SKY-FRAME ORIGINAL



PRODUCT VIDEO



A feeling of vast, wide-open space, even when the windows are shut: the seamless transition between indoors and outdoors makes Sky-Frame Original a pioneer of modern design. The frameless windows are fully transparent thanks to a track system that is concealed in the floor — the result of 20 years of development. Compatible with all Sky-Frame products, Sky-Frame Original ensures that the temperature inside remains optimal while the heat and cold remain outside.

Vertical section, Sky-Frame 2

Ceiling and floor connection (scale 1:5)

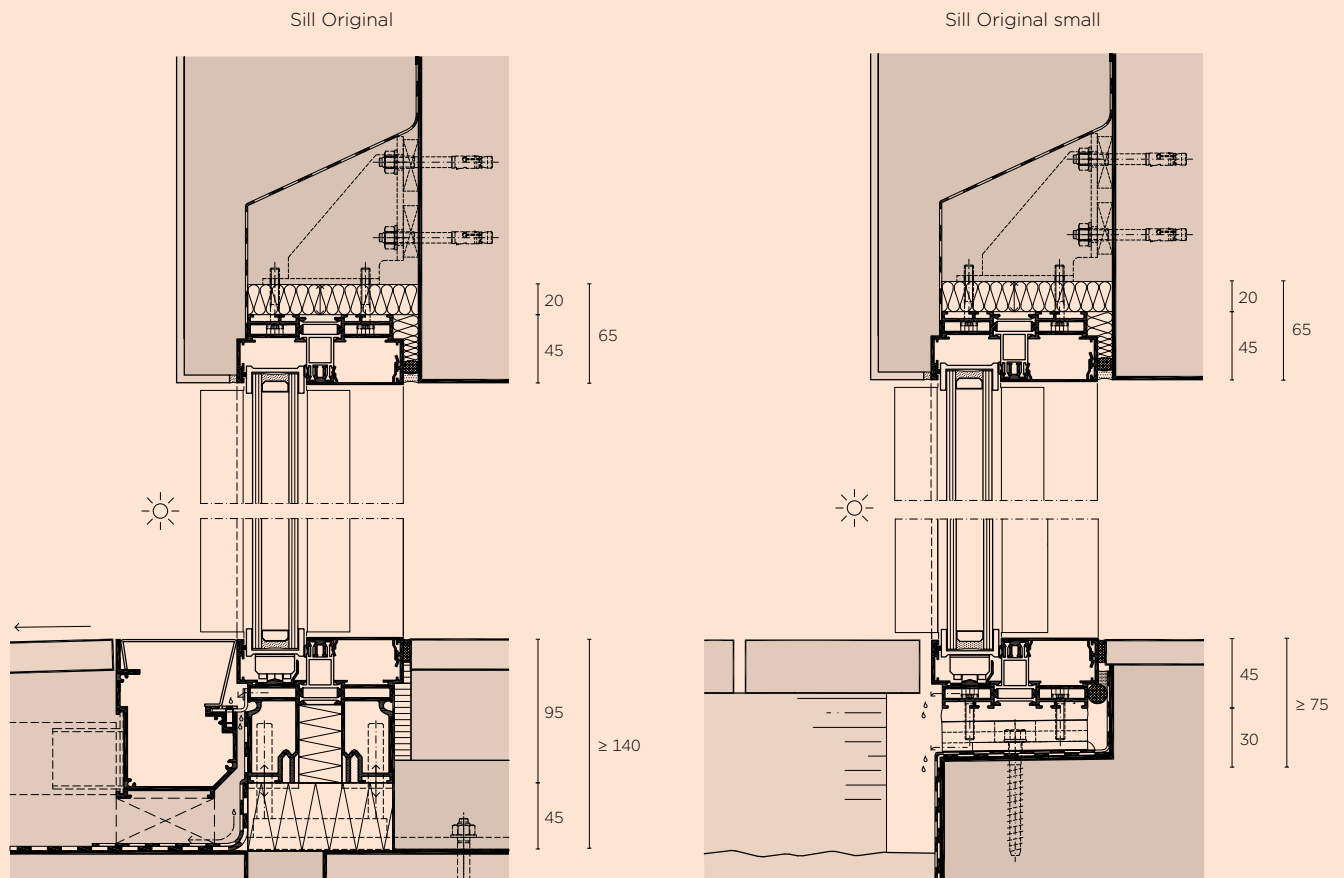

Original small sill is available for countries where a low floor structure is common and compliant.

SKY-FRAME PLAIN



PRODUCT VIDEO



What sets Sky-Frame Plain apart is the hidden transition between the inside and the outside that is flush-fitted with the floor. The sliding window glides along a narrow gap in the floor. The space between these tracks is covered by the same flooring as the interior of the room, which reinforces the feeling of a free-flowing transition between indoors and outdoors. As soon as the windows are open, this seamless transition becomes a pleasing experience. With its triple-glazed elements, Sky-Frame 3 with Option Plain is insulated to an optimum standard and can therefore also be installed in cold regions. Its innovative system layout makes maintenance and cleaning effortless, even in installed condition.

Vertical section, Sky-Frame 2 with Option Plain*
Ceiling and floor connection (scale 1:5)

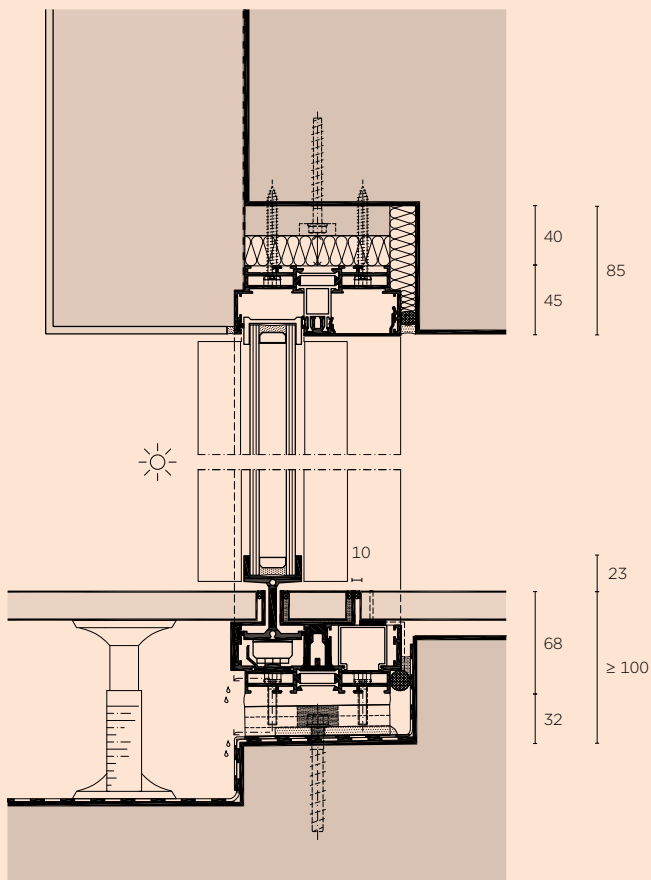

Vertical section, Sky-Frame 3 with Option Plain
Ceiling and floor connection (scale 1:5)

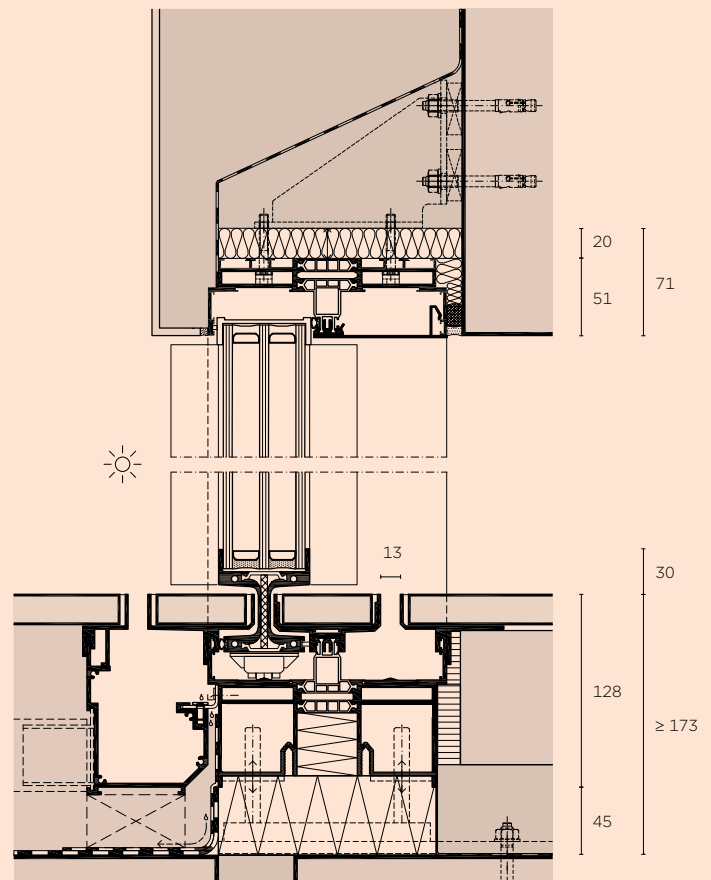

* for installation locations with a minimum annual temperature $\geq 5^{\circ}\text{C}$

SKY-FRAME 1-3



What are the requirements as regards thermal insulation, sound protection and stability against wind loads? Depending on the situation, single glazing will be sufficient or multiple glazing will be required. Sky-Frame 1-3 provides the right solution for every requirement.

Comparison (scale 1:2)

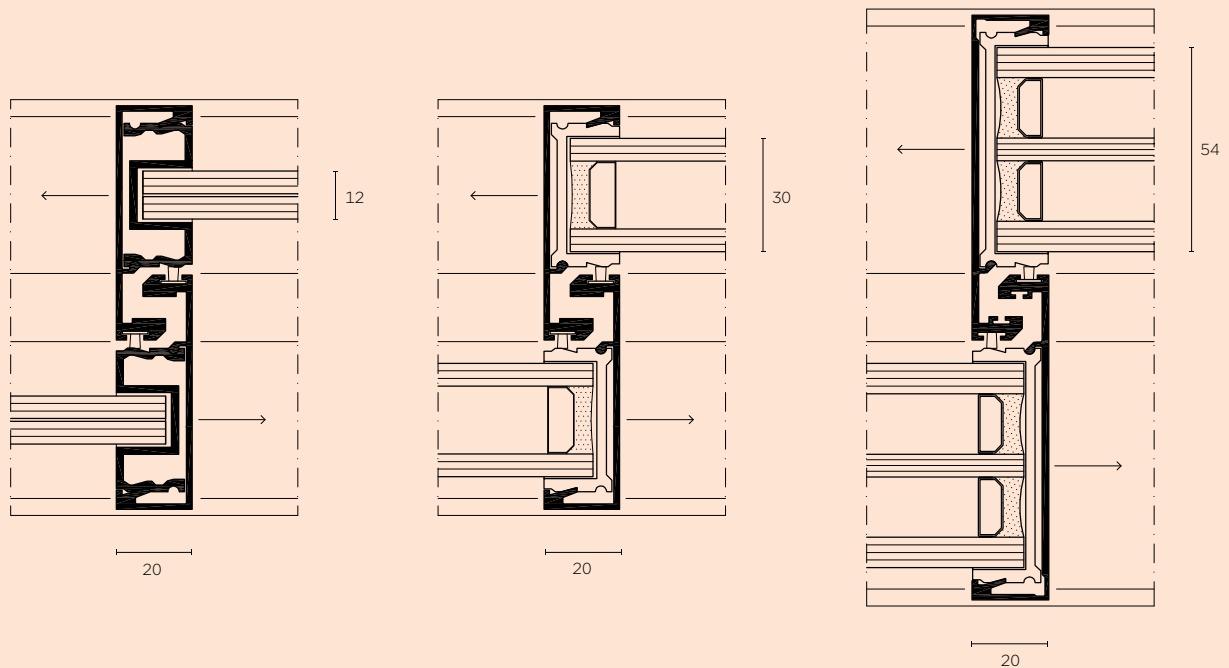

Sky-Frame 1
(glass 12 mm)

Sky-Frame 2
(glass 30 mm)

Sky-Frame 3
(glass 54 mm)

SKY-FRAME 1

The single-glazed Sky-Frame 1 units are suitable for applications without thermal insulation requirements.

Characteristics	Sky-Frame 1	Features
Panel sizes	3.2 m × 4 m (larger on request)	Sky-Frame Fly
Single glazing	12 mm	Sky-Frame Sun
Daylight / glass ratio	98%	Sky-Frame Switch
Watertightness to driving rain up to class	E750 (EN 12208 / EN 1027*)	Sky-Frame Drive: single, telescopic (3+3 sliding elements)
Air permeability up to class	4 (EN 12207 / EN 1026*)	Connection to alarm system: - Position monitoring - Deadbolt monitoring

Profile options (All profile details are referenced in our Technical Documentation)

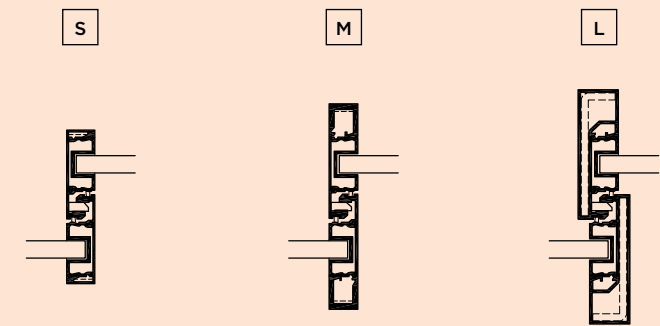

* Classification standard / test standard

Horizontal section

Side wall junctions (scale 1:5)

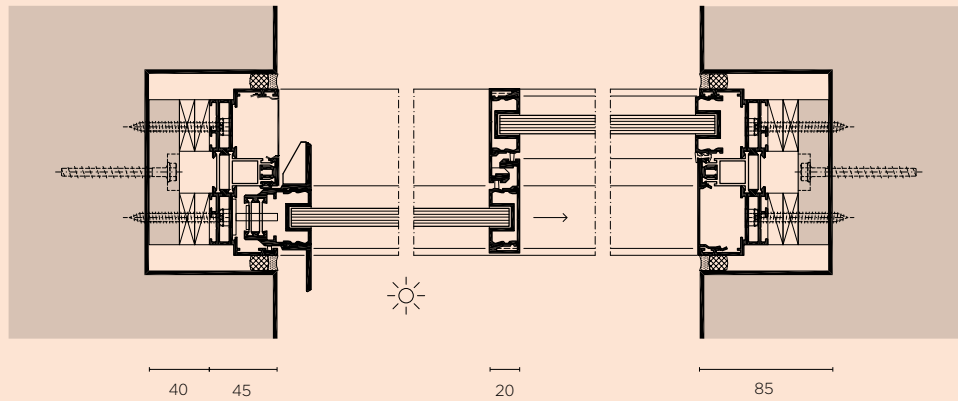
**Vertical section**

Floor and ceiling junctions (scale 1:5)

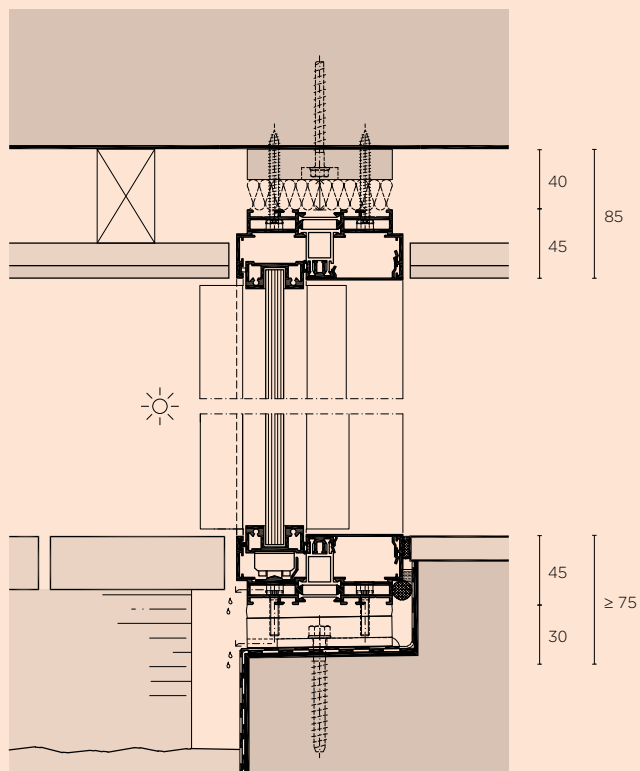

SKY-FRAME 2

The excellent sound and thermal control standards met by Sky-Frame 2 have made it the most popular Sky-Frame solution. The slim (only 30 millimetres thick) double-glazed insulating glass assembly has proved to be an outstanding performer in a wide range of climate zones.

Characteristics	Sky-Frame 2		Features
Calculation U_w (width \times height 4.6 m \times 3 m) acc. to norm	SIA 331	EN 10077	Sky-Frame Fly
Heat insulation value (glass $U_g = 1.1$)	$U_w = 1.25 \text{ W/m}^2\text{K}$	1.36 $\text{W/m}^2\text{K}$	Sky-Frame Sun
Heat insulation value (glass $U_g = 1.0$)	$U_w = 1.15 \text{ W/m}^2\text{K}$	1.27 $\text{W/m}^2\text{K}$	Sky-Frame Switch
Panel sizes	2.3 m \times 4 m (larger on request)		Sky-Frame Drive: single, telescopic (3+3 sliding elements)
Insulating glass (double glazing)	30 mm		Sky-Frame Guard:
Daylight / glass ratio	98%		- RC 2 (EN 1628, 1629, 1630 / EN 1627*)
Watertightness to driving rain up to class	E750 (EN 12208 / EN 1027*)		Connection to alarm system:
Air permeability up to class	4 (EN 12207 / EN 1026*)		- Position monitoring
Resistance to wind load up to class (SF2 Laby L St, H = 2.9 m, H/300, 2000 Pa)	C3 (EN 12210 / EN 12211*)		- Deadbolt monitoring
Anti-fall protection, category	A (DIN 18008-4)		- Glass breakage sensor
Sound insulation up to	$R_{w,P} 37 \text{ dB}$ (EN ISO 717-1 / EN ISO 10140*)		
EPD	certified (EPD-SF-27.0)		

Values apply to Sky-Frame 2 with the Original option

Profile options (All profile details are referenced in our Technical Documentation)

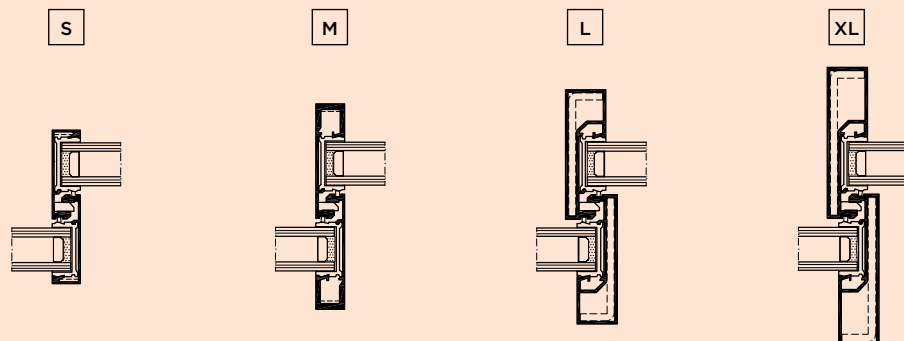

* Classification standard / test standard

Horizontal section

Side wall junctions (scale 1:5)
and temperature profile

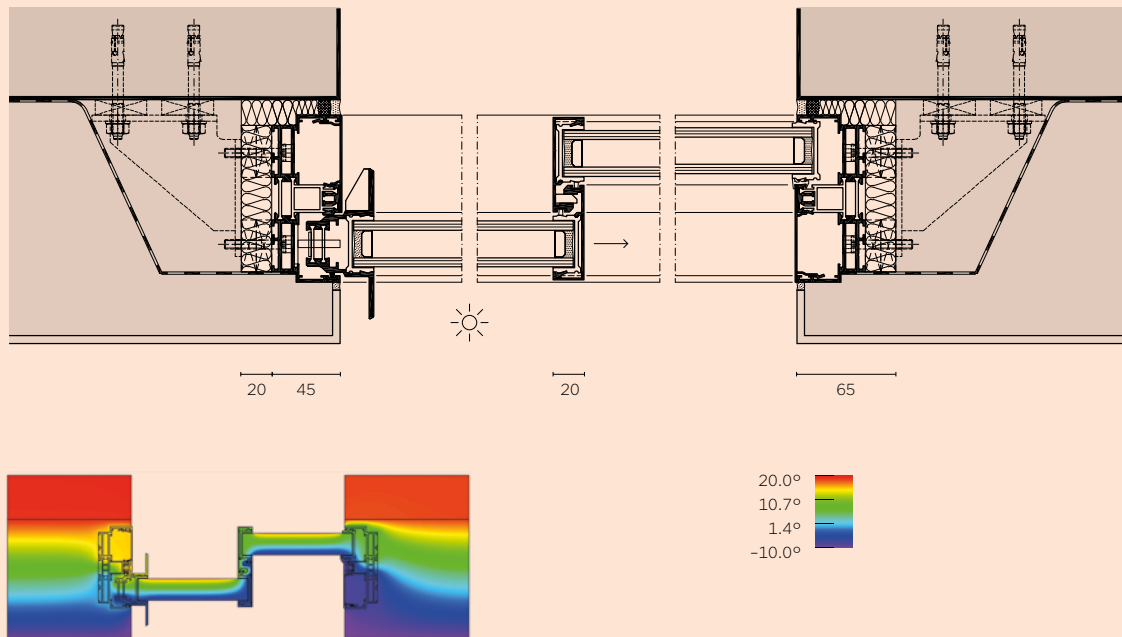
**Vertical section**

Floor and ceiling junctions (scale 1:5)
and temperature profile

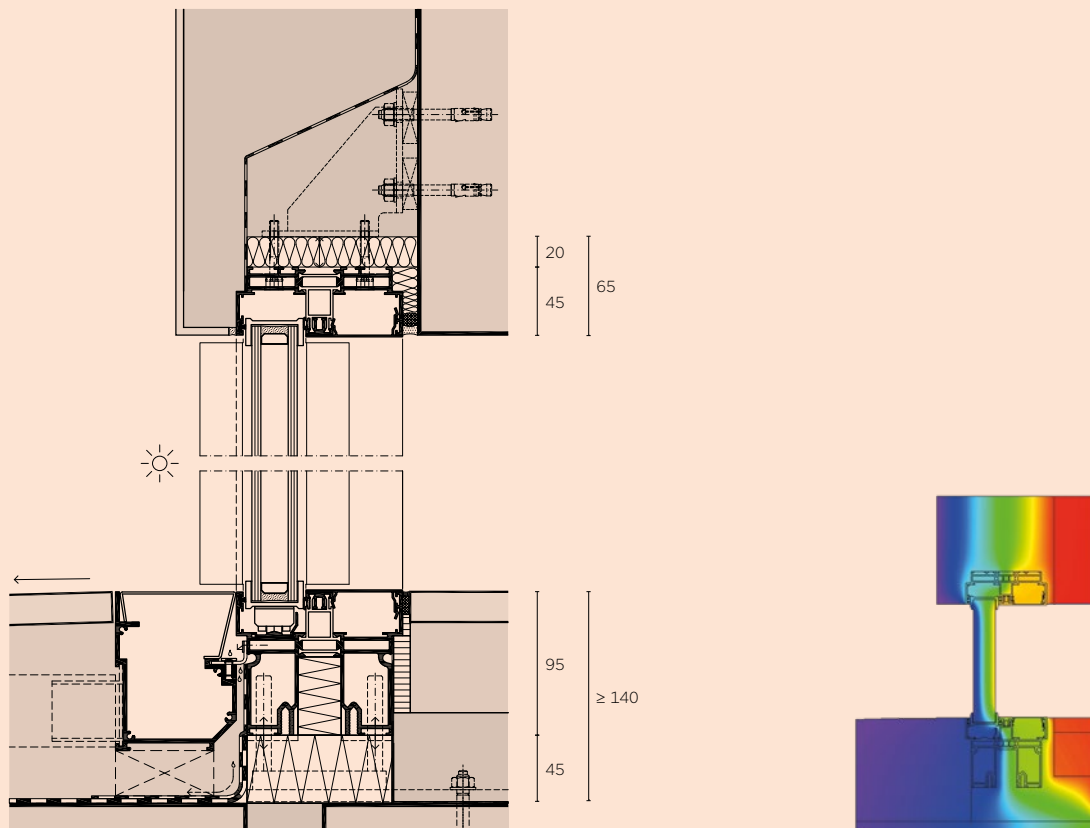

SKY-FRAME 3

The Sky-Frame 3 technology with its 54-millimetre thick insulating glass units meets the highest standards. The triple-glazed insulating panels offer extra stability and even greater resistance to wind loads. The choice between several insulation levels will insure the highest requirements in terms of thermal insulation.

Characteristics	Sky-Frame 3		Features
Calculation U_w (width × height 4.6 m × 3 m) acc. to norm	SIA 331	EN 10077	Sky-Frame Fly
Heat insulation value (glass $U_g = 0.6$)	$U_w = 0.75 \text{ W/m}^2\text{K}$	$0.87 \text{ W/m}^2\text{K}$	Sky-Frame Sun
Heat insulation value (glass $U_g = 0.5$)	$U_w = 0.66 \text{ W/m}^2\text{K}$	$0.78 \text{ W/m}^2\text{K}$	Sky-Frame Switch
Panel sizes	2.3 m × 4 m (larger on request)		Sky-Frame Drive: single, telescopic (2+2 sliding elements)
Insulating glass (triple glazing)	54 mm		Sky-Frame Guard:
Daylight / glass ratio	98%		- RC 2 (EN 1628, 1629, 1630 / EN 1627*)
Watertightness to driving rain up to class	E900 (EN 12208 / EN1027*)		Connection to alarm system:
Air permeability up to class	4 (EN 12207 / EN 1026*)		- Position monitoring
Resistance to wind load up to class (SF3 Laby L St, H = 2.9 m, H/300, 2000 Pa)	C5 (EN 12210 / EN 12211*)		- Deadbolt monitoring
Anti-fall protection, Category	A (DIN 18008-4)		- Glass breakage sensor
Sound insulation up to	$R_{w,P} 44 \text{ dB}$ (EN ISO 717-1 / EN ISO 10140*)		
MINERGIE module	certified (519.23)		
EPD	certified (EPD-SF-27.0)		

Values apply to Sky-Frame 3 with the Original option

Profile options (All profile details are referenced in our Technical Documentation)

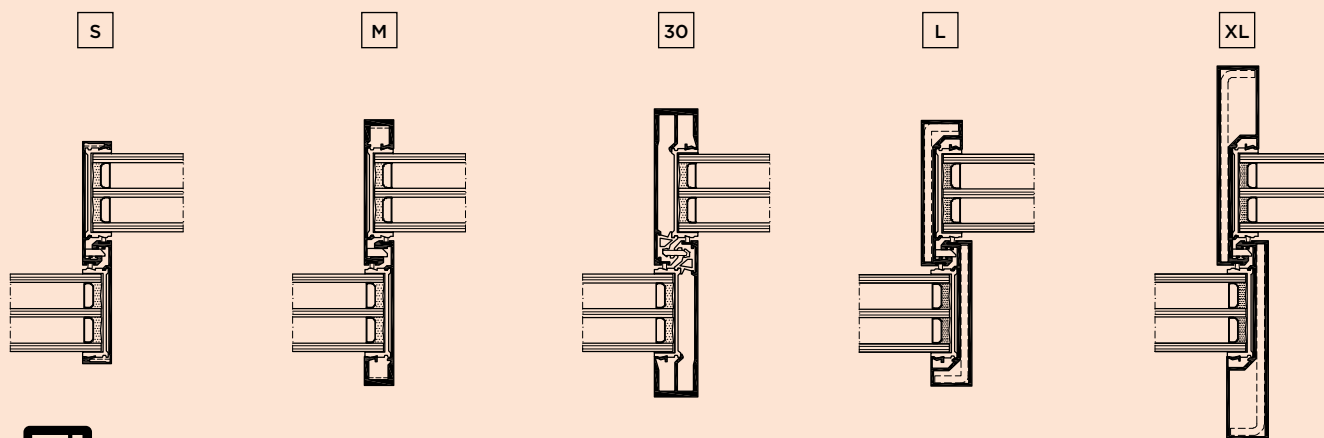

MINERGIE®

* Classification standard / test standard

Horizontal section

Side wall junctions (scale 1:5)
and temperature profile

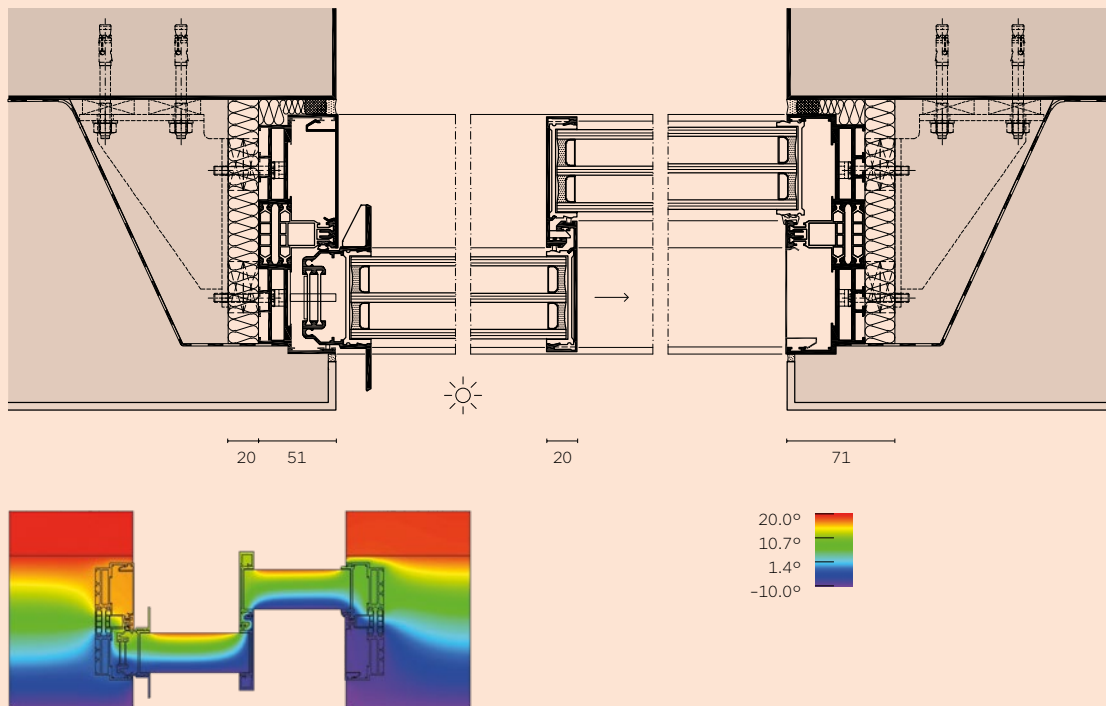
**Vertical section**

Floor and ceiling junctions (scale 1:5)
and temperature profile

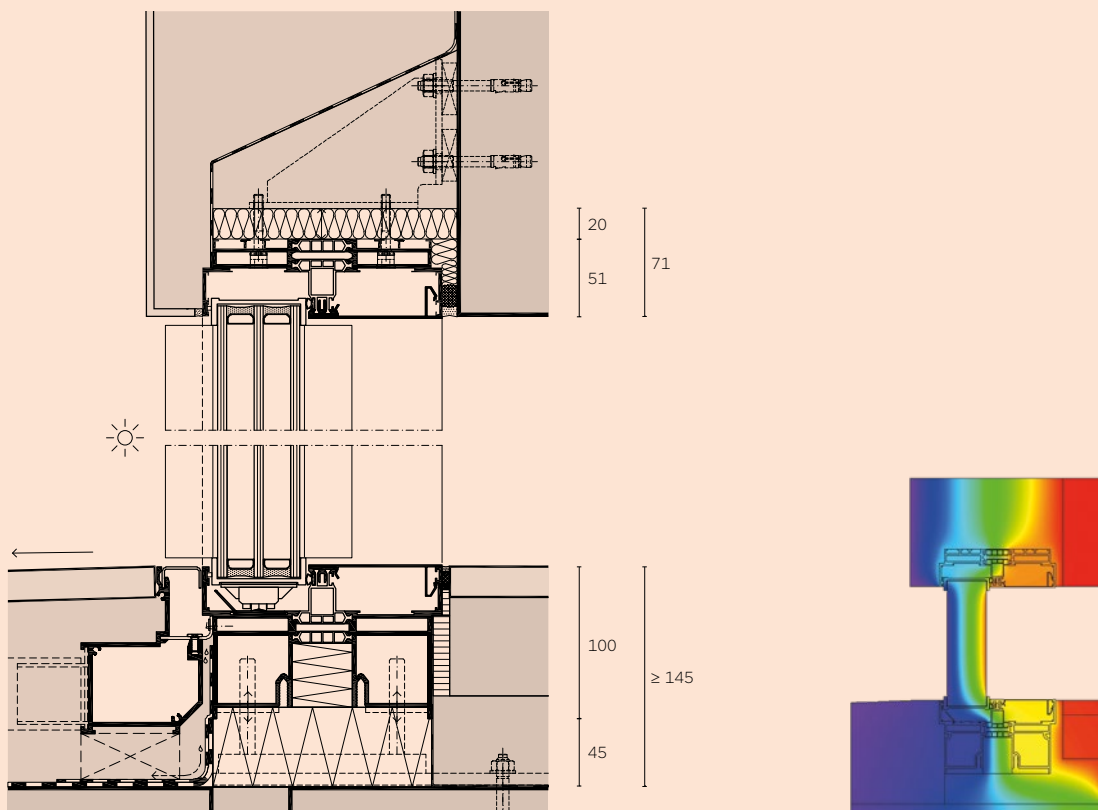

SKY-FRAME FLY



PRODUCT VIDEO



The Sky-Frame Fly insect screen is a minimalistic way to keep insects at bay. The frameless, pleated screen fully retracts into the frame when not in use. The combination of tear-resistant Vectran fiber tension cords and an integral system section guarantee maximum stability and weather resistance. Fly extends up to 1 m wide.

Horizontal section (scale 1:5)

Insect screen in closed position (top drawing)

Insect screen in open position (bottom drawing)

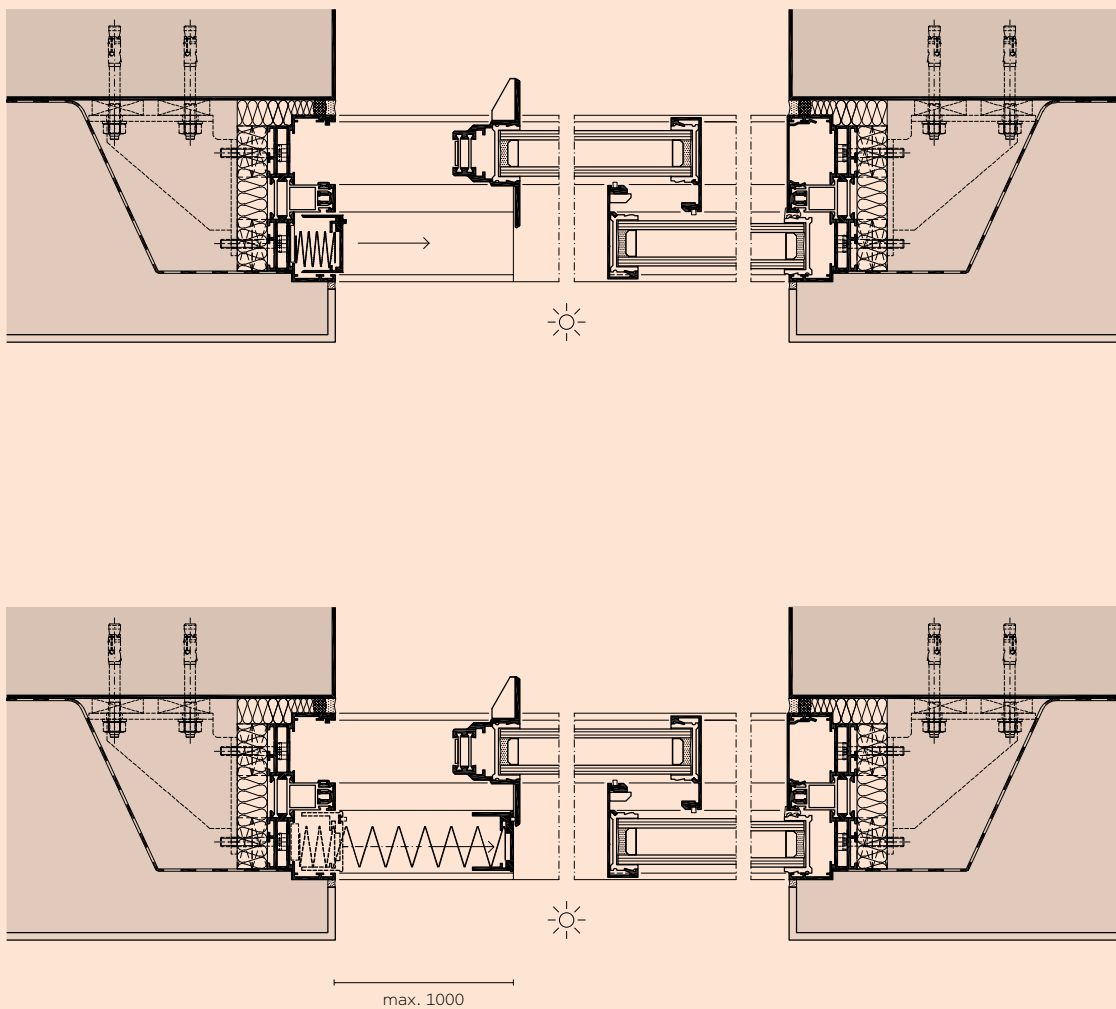

SKY-FRAME DRIVE



TOUCH



DRIVE



Sky-Frame Drive's electric drive facilitates simple and virtually noiseless operation of up to 6 (3+3) sliding panels at the press of a button. The drive is concealed in the ceiling section and allows the window panels to move automatically. The new Sky-Frame Touch control button is a convenient way to open and close sliding windows using the electric drive. Entire systems can be elegantly opened, closed or stopped at any point right at the window by applying gentle pressure on the rocker switch, which is unobtrusively integrated into the locking handle.

Side view

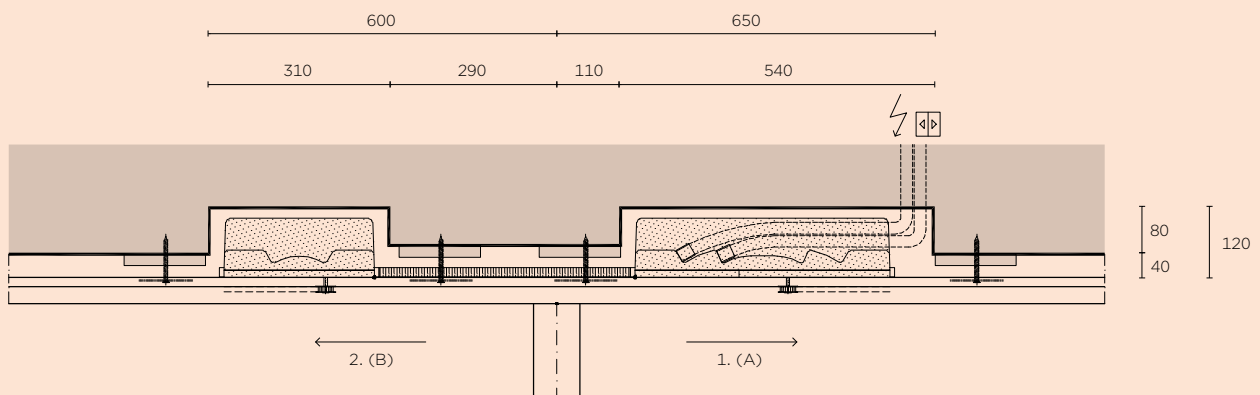

Opening options

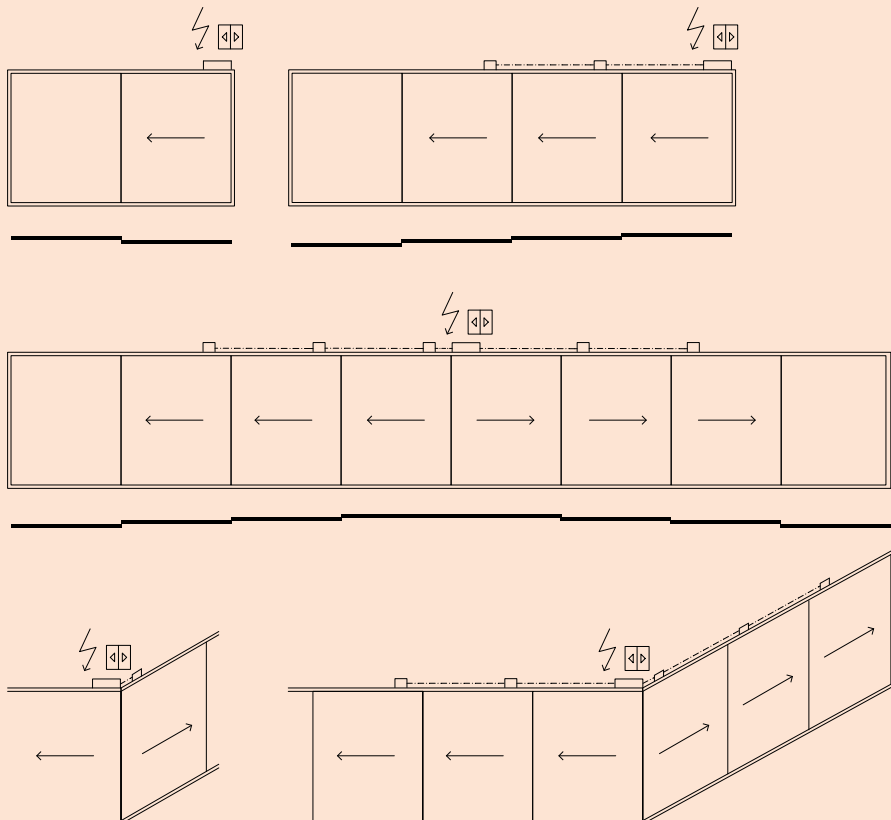

SKY-FRAME SWITCH NEW



PRODUCT VIDEO



The properties of the window glass can be controlled by an electric impulse: Switch allows toggling between transparent and opaque, or activating solar shading to regulate heat input into the building. This works for both fixed and sliding elements, in any position, even while sliding. The required cable routing is completely invisible. With Sky-Frame 3, Switch can also be combined with an electric drive.

Switch Variants

Switch Privacy (Transparency)

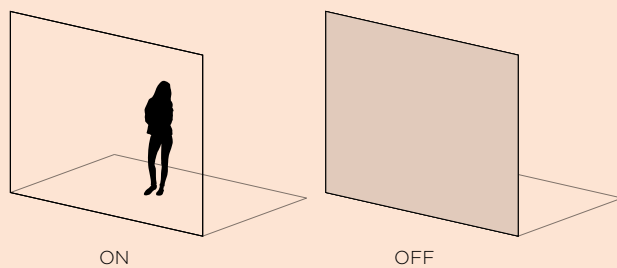

Switch Sun (Solar heat gain)

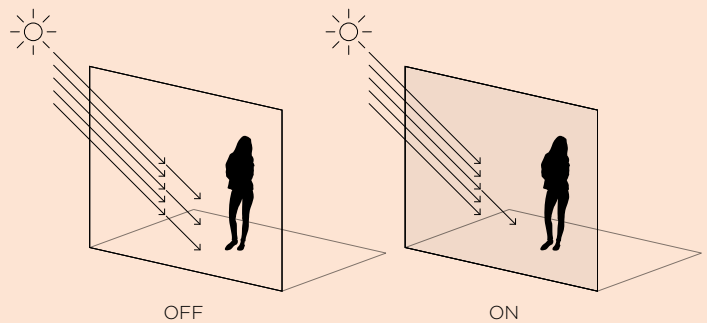

Opening Options Examples

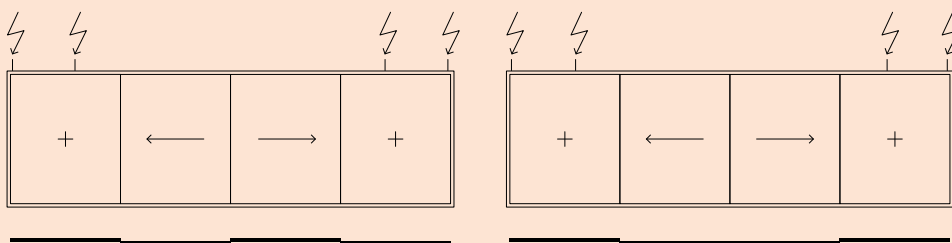
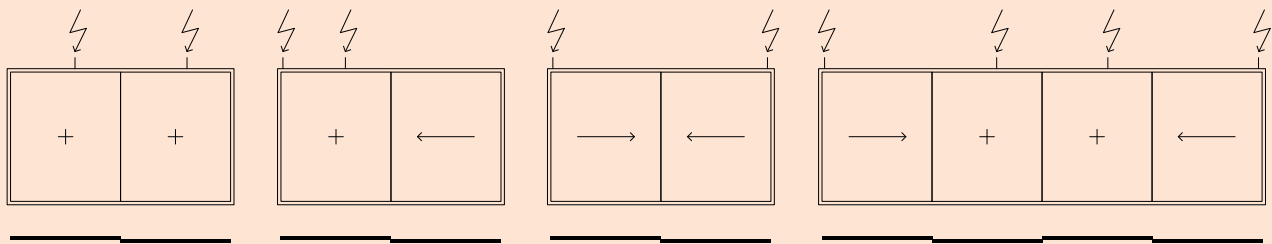

SKY-FRAME POCKET



PRODUCT VIDEO



With the Sky-Frame Pocket solution, rooms can be completely opened up without any visible glass leaves. The sliding panels are recessed and hidden away from sight. Additional features such as Sky-Frame Drive (electrically driven opening and closing) are also available.

Horizontal section, Sky-Frame 3

Side wall junction (scale 1:5)

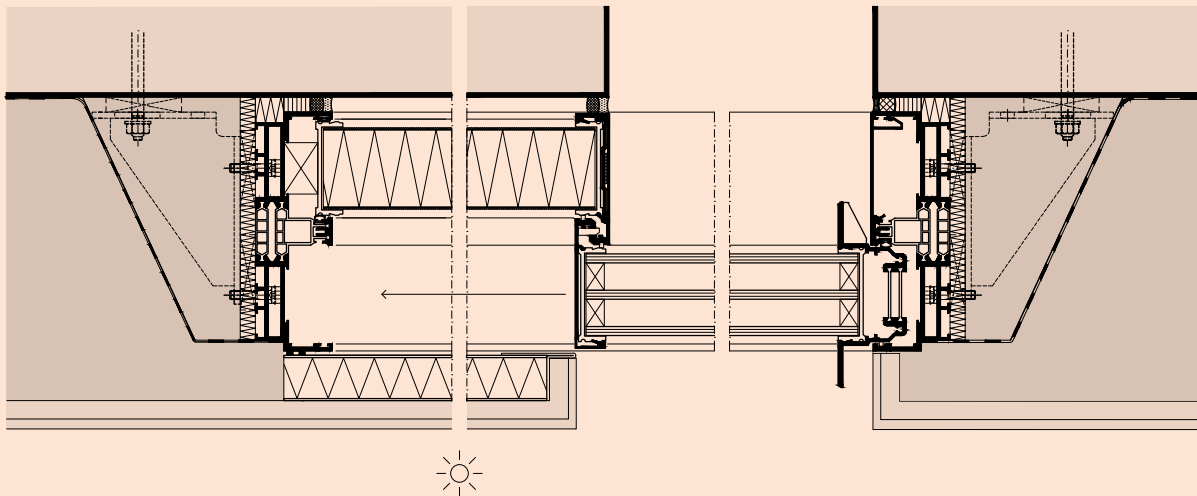

Opening options

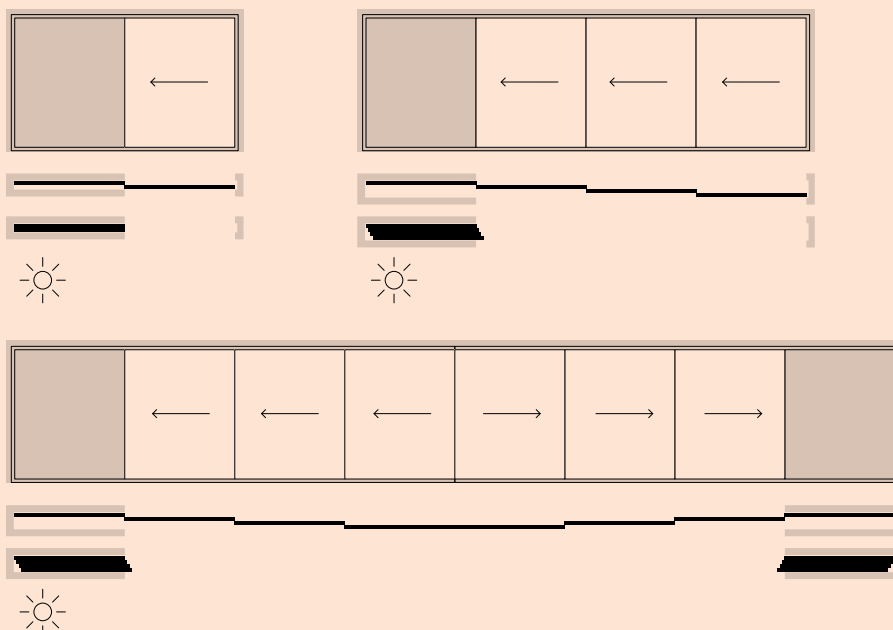

SKY-FRAME INLINE



The Sky-Frame system is supplemented by elegant filigree posts, which has a minimal visible width of just 30 mm. It is available in three installation depths (66/90/110 mm) and can be reinforced with up to four steel profile inserts for higher static specifications. Frameless fixed glass panels can therefore be combined with sliding windows over large areas, forming a flush, continuous glass membrane.

Sky-Frame 2

Double glazing (scale 1:5)

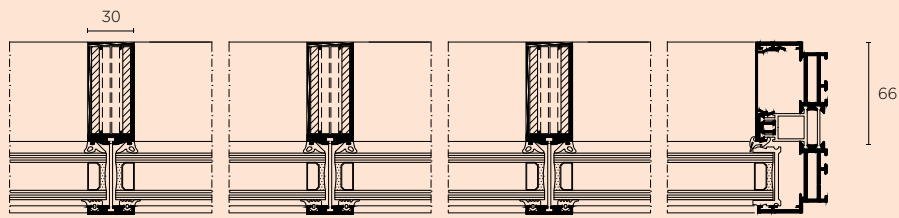
**Sky-Frame 3**

Filigree post combined with sliding panel (scale 1:5)

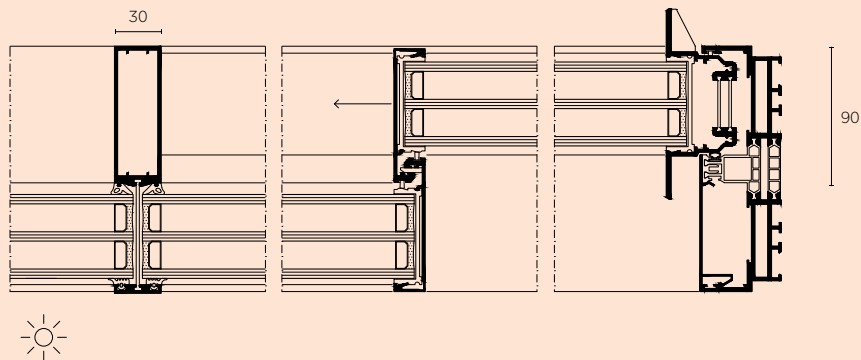

SKY-FRAME GUARD



Sky-Frame Guard offers outstanding burglar resistance thanks to an adhesive bond between the insulating glass assembly and the GRP sections, as well as a multi-point locking system. Various additional components are available to meet further security requirements.

Electronic components

- P: Position monitoring (leaf)
- R: Deadbolt monitoring (lock)
- G: Glass breakage sensor (alarm loop)

These three security parameters can be electronically monitored by alarm sensors concealed in the unit, and the status information can be transmitted to a burglar alarm system.

Mechanical components

The Sky-Frame 2 and Sky-Frame 3 technologies have been inspected by ift Rosenheim and comply with the following anti-burglary protection class:

RC 2 (EN 1628, 1629, 1630 / EN 1627)

up to RC 4 + PAS24 on request

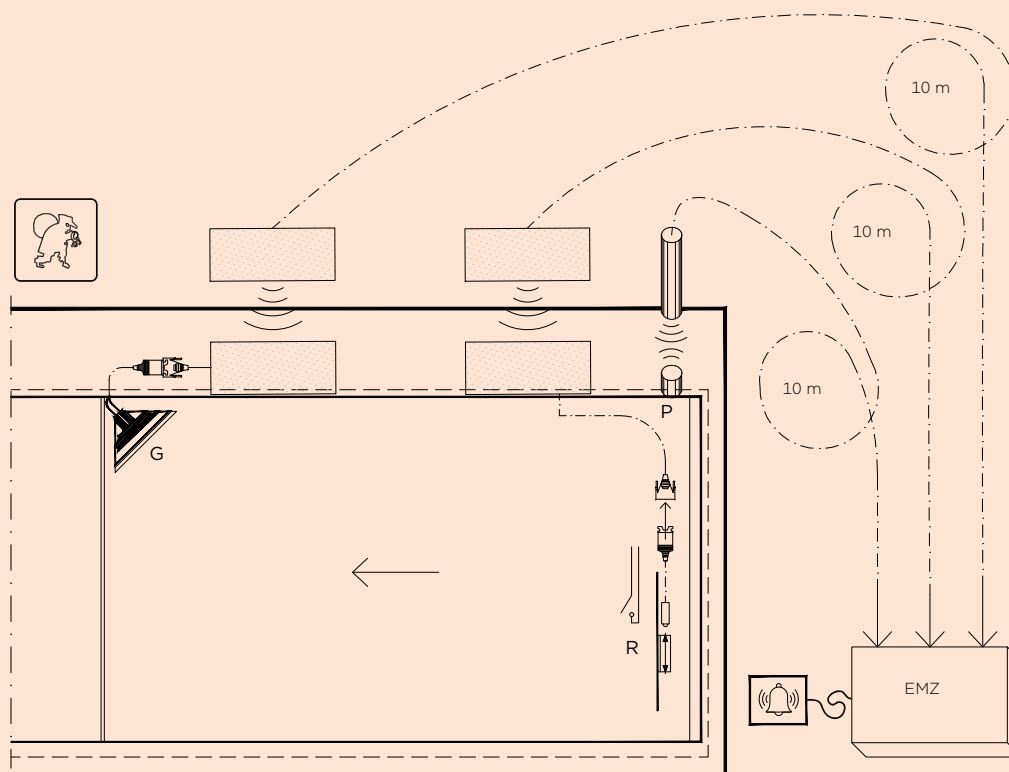

SKY-FRAME GUN



With special insulated security glass (2-IG with bullet resistant glass), reinforced frames, vertical profiles and defined building joints, Sky-Frame 3 Gun ensures optimal protection from gunfire.

The Swiss Federal Office for Defence Procurement armasuisse has rated Sky-Frame 3 Gun as FB4, NS (.44 Magnum, no spall).

Bullet resistance

Reinforced profiles with bulletproof glass (scale 1:5)

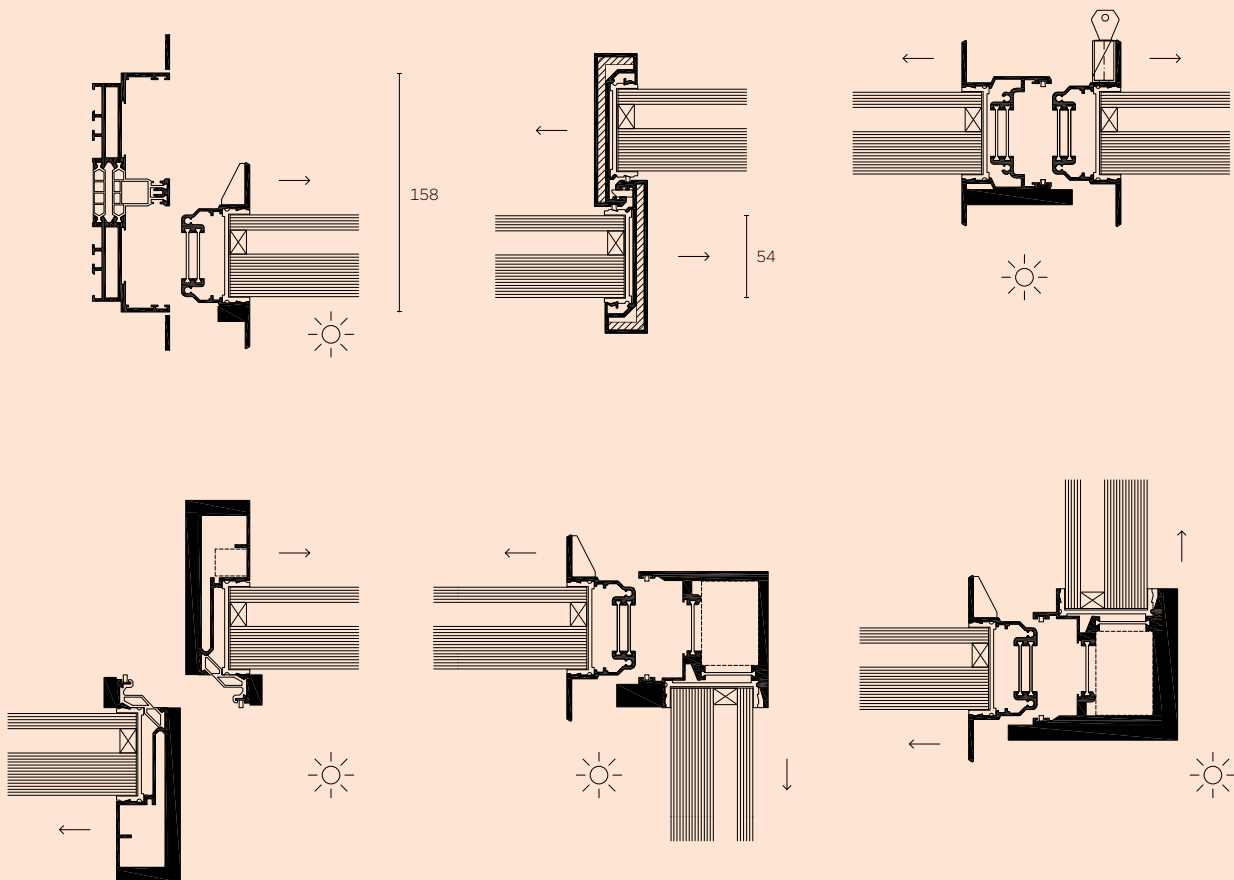

SKY-FRAME HURRICANE



Sky-Frame Hurricane sliding doors have exceeded the most stringent hurricane impact tests, and are compliant with the High Velocity Hurricane Zone (HVHZ) criteria as defined by the Florida Building Code – considered to be the gold standard in the industry. Fulfilling the requirements of Miami- Dade County, Sky-Frame's 2.3 m × 3.5 m panels are one of the largest hurricane-rated frameless sliding doors on the world market. The values of 1,200 Pa (25 psf) reached during the driving-rain tests are among the world's highest, and greatly contribute to the water-resistance of the windows. The sliding doors can be motorized or manually operated with a wide range of opening options and a slim 29 mm sight line offers an unbounded spatial experience for exceptional architecture. Multi-tracks allow an unlimited number of sliding doors to be installed next to each other.

SKY-FRAME HURRICANE

Characteristics	Sky-Frame 3 Hurricane	Sky-Frame 3 Hurricane	Features
Design pressure	3.1 kN/m ² 65 psf	3.6 kN/m ² 75 psf	Sky-Frame Pocket
Sliding or fixed panel (max. width × height)	2311 mm × 3505 mm *7'7" × 11'6"	1524 mm × 3505 mm *5' × 11'6"	Sky-Frame Fly
Max. panel area *all possible dimensions on request	87 ft ² 8.1 m ²	75 ft ² 6.9 m ²	Sky-Frame Drive
Insulating glass (double glazing)	40.5 mm 1 5/8" LSG-TSG 6/6.6 SGP / 12 / LSG-TSG 6/6.6 SGP		Sky-Frame Guard: Connection to alarm system: - Deadbolt monitoring - Position monitoring
Watertightness to driving rain up to	1200 Pa (25 psf)		
Rating (Tas 201/202/203)	HVHZ, wind zone 4, large and small missile impact		
NFRC	available		

Configuration

Number of tracks	2-4
Number of panels	no limit
Configuration restrictions	no sliding element on the inner track
Steel-reinforced labyrinth	available
Centre opening offset	available
Centre opening on same level	available
Edge opening	available
Corner opening	not available
Fixed corner glazing	not available
Inline	not available

Institute / Authority

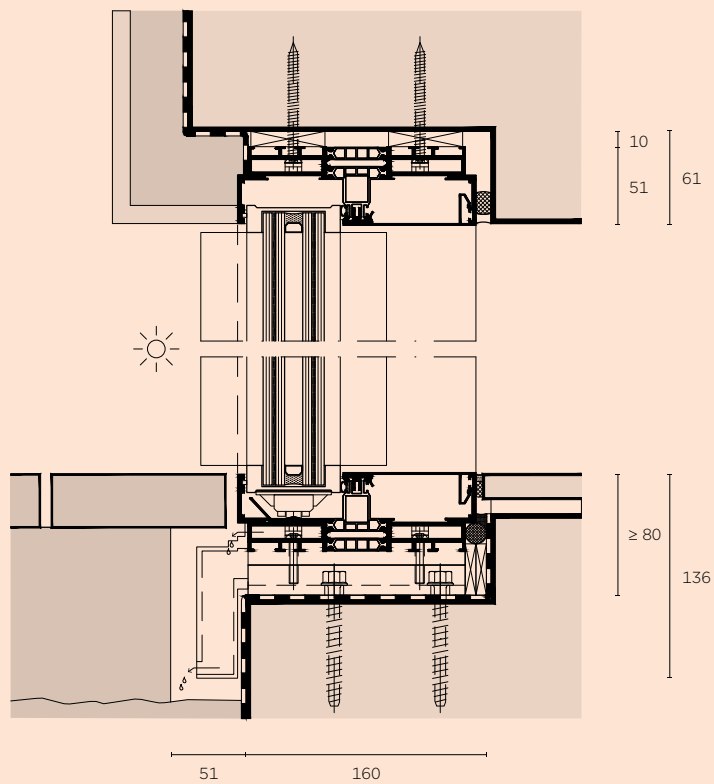
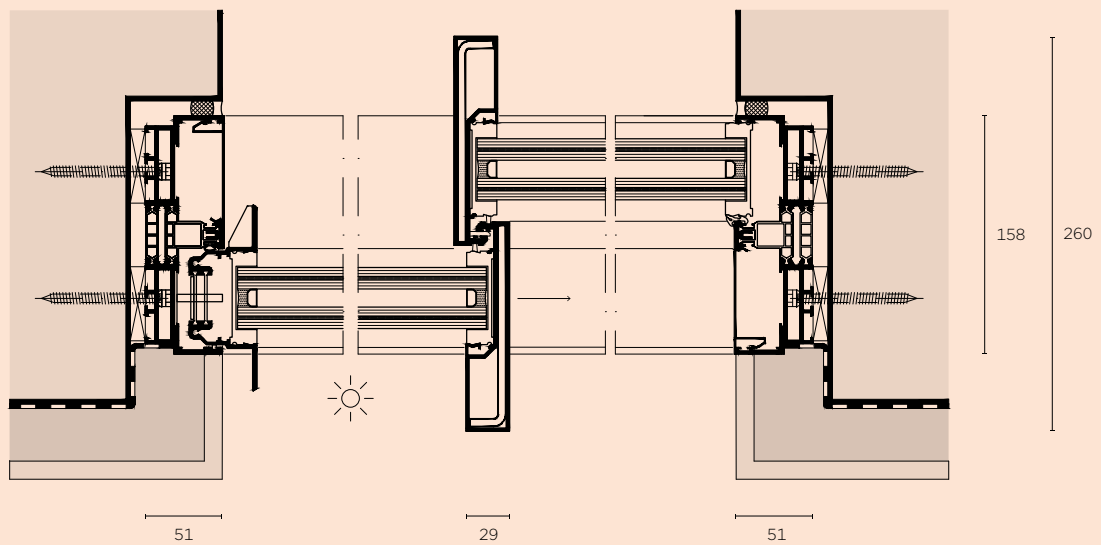

Horizontal section
(M 1:5)**Vertical section, 2 tracks**
(M 1:5)

SKY-FRAME SUN



The Sun venetian blind system with its flat, 80 mm wide aluminium slats offers the perfect solar shading solution for the elegant Sky-Frame sliding windows. Slats that measure up to 3 m width and with a maximum height of 4 m are suspended on plastic-sheathed guide cords. The Sun box is recessed into the floor and the winding mechanism in the blind box facilitates swift dismantling of the guide cords to create an unobstructed opening as well as their subsequent reinstallation.

Horizontal section

(scale 1:10)

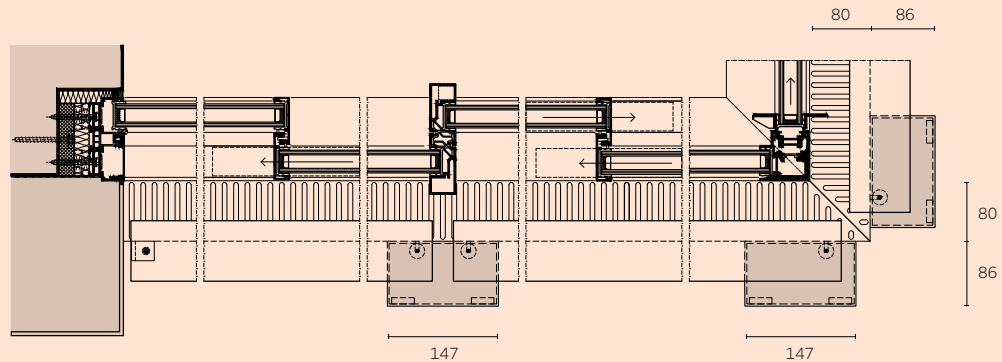

Vertical section

(scale 1:10)

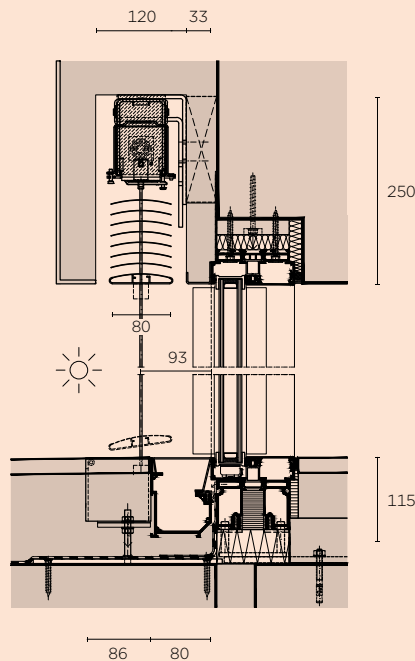

SKY-FRAME COLOR



Create your own Sky-Frame sliding windows: choose the profile colour and we will bring your vision to life. The sliding-window system you choose will be assembled by highly experienced glaziers, metalworkers and coating specialists who work with real diligence and have a passion for what they do.

Unique colours

In addition to the anodized colours shown below, you can choose any colour from a range of palettes (RAL, IGP, DB) for the powder coating.



Anodized colours



E6 EV1
colourless anodized
standard



Colinal 3115
chemically matted
surcharge

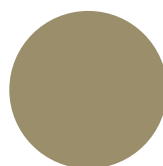

Colinal 3145
chemically matted
surcharge

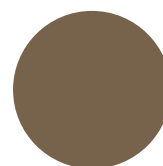

Colinal 3165
chemically matted
surcharge

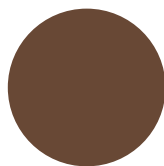

Colinal 3175
chemically matted
surcharge

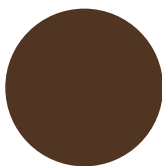

Colinal 3178
chemically matted
surcharge

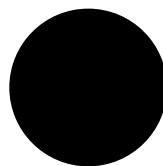

Colinal 3180
chemically matted
surcharge

SWISS MADE.



The spectacular frameless glass panels and flush transitions allow inside and outside to merge seamlessly into one another to form a living space. Ever since the first Sky-Frame window was installed in 2002, the Swiss company has helped to make more than 10 000 individual lifestyle dreams come true and create innovative living spaces around the world.

Sky-Frame develops and manufactures all of its premium products in Switzerland and regularly wins renowned design and business awards. Together with universities and research institutions, Sky-Frame continuously drives forward new solutions for ambitious living concepts.

Sky-Frame's immense passion and in-depth understanding of architecture, spatial design and technology has made it the leading international supplier of frameless sliding window systems.



WE LOVE WHAT WE DO. REFERENCES.



1

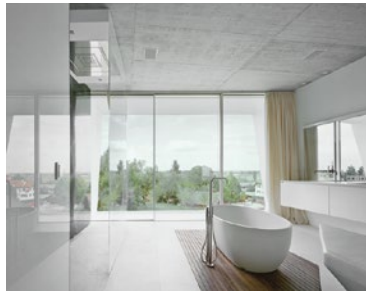

2



3



4

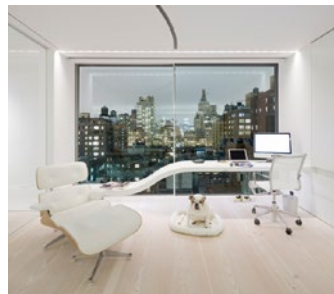

5



6



7



8

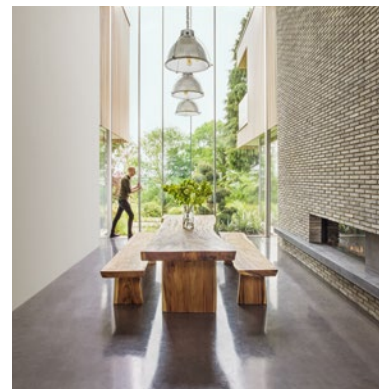

9

1, 2 Wohnhaus Freundorf, Austria. Architecture: Project A01, Austria. 3 Vitrahaus, Germany. Architecture: Herzog & de Meuron, Switzerland.
4 Villa in Utrecht, Netherlands. Architecture: Zecc Architects BV, Netherlands. 5 Penthouse in New York, USA. Architecture: UNStudio, Netherlands.
6 Haus G, Germany. Architecture: ATP Sphere, Netherlands. 7 Villa Kavel 01, Netherlands. Architecture: Studioninedots, Netherlands.
8 Orum, USA. Architecture: SPF:architects, USA. 9 Caversham, United Kingdom. Architecture: Gregory Phillips Architects, United Kingdom.

Head Office

Sky-Frame Frauenfeld, Switzerland

Sky-Frame Branches

Austria, Vienna
Great Britain, London
Italy, Milan
Switzerland, Rothrist
USA, Los Angeles

Sky-Frame Partners

Global presence through
selected partners

www.sky-frame.com

For further details,
please visit our website

Architecture

Will Architektur, Austria (cover page, page 20)
Bembé und Dellinger Architekten, Germany (page 8)
Lab 32 Architecten, Netherlands (page 10)
Oppenheim Architecture, Switzerland (page 14)
Sergio Caverio, Switzerland (page 16)
Tec Architecture, Switzerland (page 28)
Peter Pichler Architecture, Italy (page 30)
Alfredo Vanotti, Italy (page 32)
Biehler Weith Associated, Germany (page 34)
Gus Wüstemann, Switzerland and Spain (page 36)
Zoran Bodrozic, Austria (page 40)
Peter Kunz, Switzerland (page 50)

Copyright

© 2025 Sky-Frame

Concept and Design

STUDIO NEO, Switzerland

Text

Jung von Matt, Switzerland

Photography

Paul Ott, Austria (cover page, page 20)
Brigida González, Germany (page 8, 16, 34, 52)
René de Wit, Netherlands (page 10)
Zooey Braun, Germany (page 14)
Bruno Helbling, Switzerland (page 28, 36)
Oskar da Riz, Italy (page 30)
Marcello Mariana, Italy (page 32)
Robert Niederl Photography, Austria (page 40)
Claudia Luperto, Switzerland (page 50)
Mel Yates, United Kingdom (page 52)
Matthew Momberger, USA (page 52)
Cornbread Works, Netherlands (page 52)
Tom Bisig, Switzerland (page 52)
Peter Cuypers, Netherlands (page 52)
Iwan Baan, Netherlands (page 52)

SKY-FRAME

**A VIEW,
NOT A
WINDOW.**